

Open Burning Request Form Instructions

Personal Information

This information is used to notify you of the approval or denial of the request. Response will be emailed to address provided. Phone number information allows us to contact you if we have additional questions concerning your request.

Open burning site information

- 1) A sketch of the site/location of the burn and nearby structures will allow Ohio EPA to determine if the burn will be conducted within the rule-based setback requirements. No burn is allowed within 1,000 feet of an off-site dwelling (e.g., your neighbor's house) in certain instances. Below is an example of an acceptable sketch.

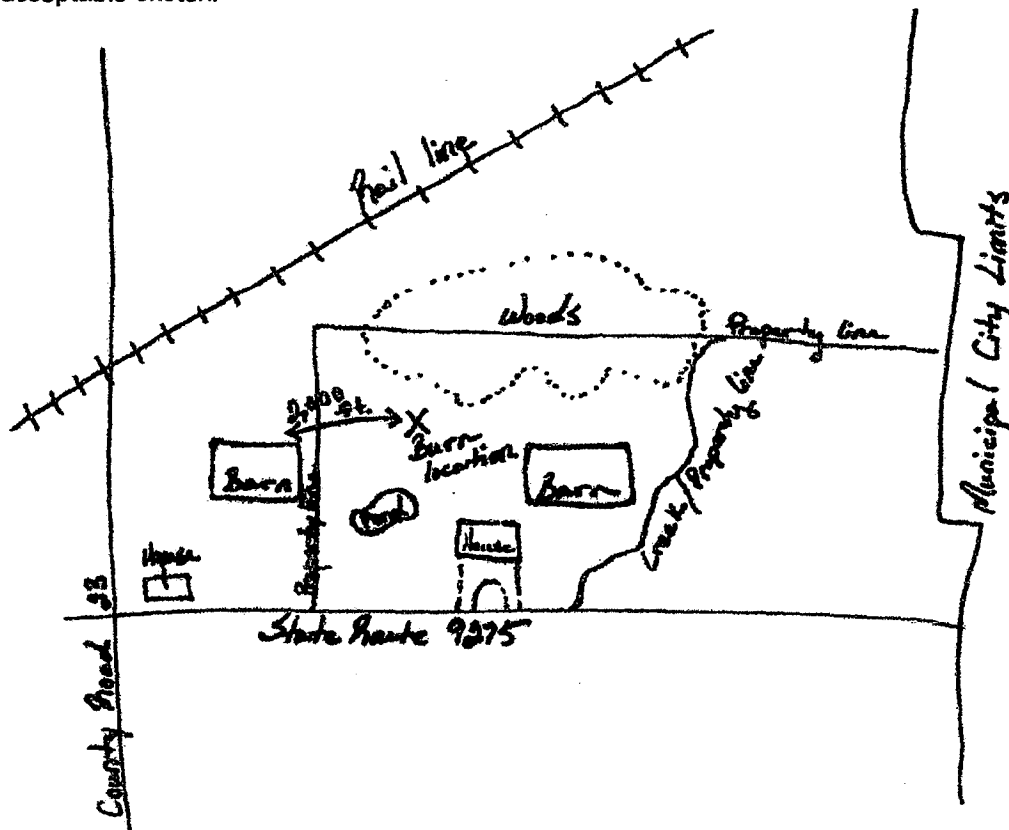

- 2) Please identify the category that best fits the reason you want to conduct a burn and describe the purpose for the burn. This information will assist fire department in determining if the requested burn is permissible under Ohio law. Please remember that if you are disposing of land clearing waste, you need to make sure the fire is set only when atmospheric conditions will readily dissipate the air contaminants; the fire does not create a visibility hazard on roadways; and the fire is located at a point on the premises no less than one thousand feet from any inhabited building not located on the premises where the burn will occur.
- 3) Please describe the materials to be burned. This information is helpful in determining if the materials to be burned can be legally burned in Ohio. This is particularly important if there is a mixture of proposed materials. If there is a mixture, fire department can provide specific conditions in the approval letter allowing some materials to be burned while notifying you of which other materials cannot be burned. Inadequate description of the materials to be burned may result in denial of burning certain materials that may otherwise be legal.

Open Burning Request Form Instructions

- 4) The material to be burned must originate from the site where it is to be burned. Material can be moved within a contiguous site to ensure distance setback requirements for off-site structures. However, moving materials from one site to another is not permitted by rule. Please provide sufficiently detailed information in 1 above if materials are moved within the proposed site.
- 5) Ohio open burning regulations are broken down into "restricted" and "unrestricted" areas. Different standards apply based on proximity to populated areas. Please identify if your proposed burn site meets the restricted versus unrestricted area designation.
- 6) Approved open burning must be attended to during the duration of the burn. As a result, some burns may extend beyond a single day. Please identify the dates/times the burn is proposed to cover. Please note that this is not the same as multiple burns over time. The purpose of question 7 is to identify those burns that are intended to be continuous but cannot be due to personnel resources, expected weather conditions, etc.